

Collinear 4 dB Mobile Antenna for the 900 MHz Band

DESCRIPTION

- 4 dB mobile antenna with encapsulated phasing coil.
- Black-chromed stainless steel whip.
- Models available for the most common 900 MHz cellular networks.
- Stainless steel LX-mount – professional quality in elegant and smooth design.
- Especially suited for roof-mounting.
- Provided with FME-connection (supplied without cable).
- Bendable section in mount for adjustment of whip (tiltable 15° by hand).
- Installation with access from the outside only (requiring an 18 mm dia. hole).



SPECIFICATIONS

| Electrical | |
|---------------------|--|
| Model | MU 911-LX/... |
| Frequency | 900 MHz band covered by three models |
| Antenna Type | Collinear mobile antenna |
| Max. Input Power | 60 W |
| Polarisation | Vertical |
| Impedance | 50 Ω |
| VSWR | ≤ 1.3 @ f. res. |
| Bandwidth | ≥ 40 @ VSWR ≤ 1.5 ≥ 80 @ VSWR ≤ 2.0 |
| Gain (EIA RS-329-1) | 4 dB |

| Mechanical | |
|---------------------|--|
| Materials | Whip : Stainless steel and black-chromed brass Durable plastics Mount : Stainless steel Brass Weather- and shockproof plastics |
| Cable | FME-cable to be ordered separately |
| Installation Torque | 3.5 Nm max. |
| Colour | Black |
| Height | Approx. 300 mm / 11.81 in. |
| Weight | Approx. 0.058 kg / 0.13 lb. |
| Mounting | 18 mm dia. hole |

ORDERING

| Model | Product No. | Frequency |
|-------------|-------------|--------------------------------|
| MU 911-LX/l | 130001237 | 824 - 894 MHz (EAMPS) |
| MU 911-LX/m | 130001512 | 870 - 950 MHz (ETACS) |
| MU 911-LX/h | 130001236 | 880 - 960 MHz (EGSM & NMT-900) |

INSTALLATION

The LX-mount is especially suited for roof-mounting. It is recommended to mount the antenna at the centre of the roof to ensure the best omnidirectional coverage. Mounting can take place in an 18 mm dia. hole with access from the outside only. When cleaning the car in car-washing machines, the whip should be removed – a 9 mm fork spanner can be used. After wash, the whip is refitted and tightened lightly with the spanner. The mount is equipped with a bendable section ($\pm 15^\circ$) to make it possible to adjust the antenna to an upright position.

PLEASE NOTE

When tightening the revolving nut (see picture 4), special care must be taken to keep the spanner in the correct position.

3. TUNING

The antenna is delivered factory-tuned and requires no further tuning.

1. INSTALLATION DIMENSION

LX-MOUNT

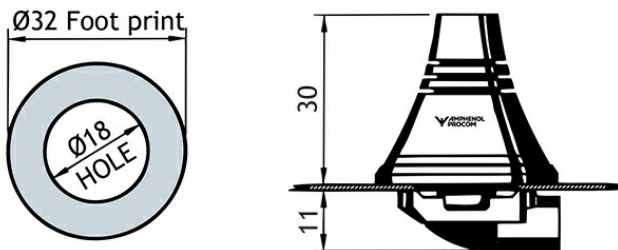

2. INSTALLATION STEPS

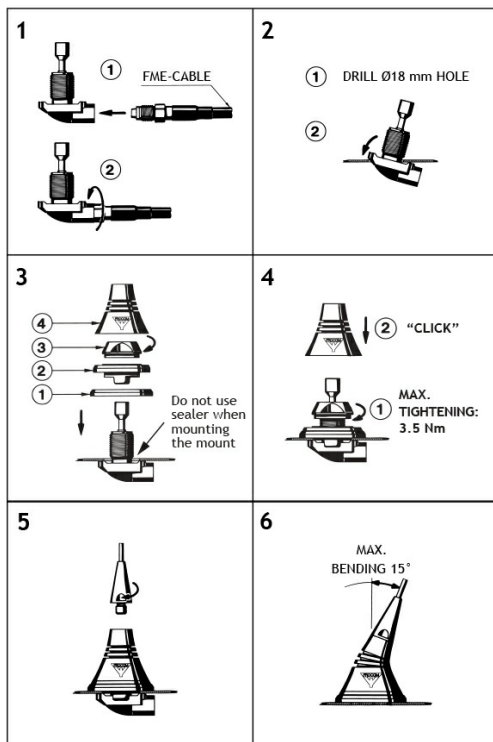

Do not use sealer on rubber gasket or other places.

