

2-Channel Wilkinson Power Combiner / Divider for the 68-88 MHz band

DESCRIPTION

- Combines two transmitters or receivers on the same antenna.
- Better utilization of good antenna position.
- The only combining option with very small Tx-Tx frequency spacing.
- 30 W load built-in.
- Two antennas on the same transmitter or receiver.
- Symmetrical 1:1 dividing ratio (-3 dB) or asymmetrical 1:4 (-6 dB) or 1:10 (-10 dB) dividing ratio.
- N-female on all ports (other types on request).



SPECIFICATIONS

Electrical	
Model	PRO-MPHY68-88-2-... dB
Filter Type	Cascaded Wilkinson
Max. Input Power	30 W per channel when used as a power combiner. 60 W when used as a power divider. Note: When used as a power combiner, extra cooling is necessary. At 2 x 30 W the unit requires a heatsink with $R_{th} \leq 3^{\circ}\text{C/W}$.
Insertion Loss	-3 dB : < 3.5 dB -6 dB : High power port < 2 dB Low power port 6 dB \pm 1 dB -10 dB : High power port < 1 dB Low power port 10 dB \pm 1 dB
Impedance	50 Ω
Isolation	-3 dB : > 20 dB -6 dB : > 18 dB -10 dB : > 18 dB
VSWR	-3 dB : < 1.3 -6 dB : < 2.0 -10 dB : < 2.0 all other ports terminated with 50 Ω
No. of channels	2
Mechanical	
Connection(s)	N(f) (other types as option)
Dimensions	129 (incl. conn.) x 152 (incl. flanges) x 35 mm / 5.08 x 5.98 x 1.38 in.
Weight	Approx. 0.45 kg / 0.99 lb.
Environmental	
Operating temperature range	-30 $^{\circ}\text{C}$ to +60 $^{\circ}\text{C}$

ORDERING

Model	Product No.
PRO-MPHY68-88-2-3 dB-N(f)	210000657
PRO-MPHY68-88-2-6 dB-N(f)	210000748
PRO-MPHY68-88-2-10 dB-N(f)	210000742

TYPICAL RESPONSE CURVE

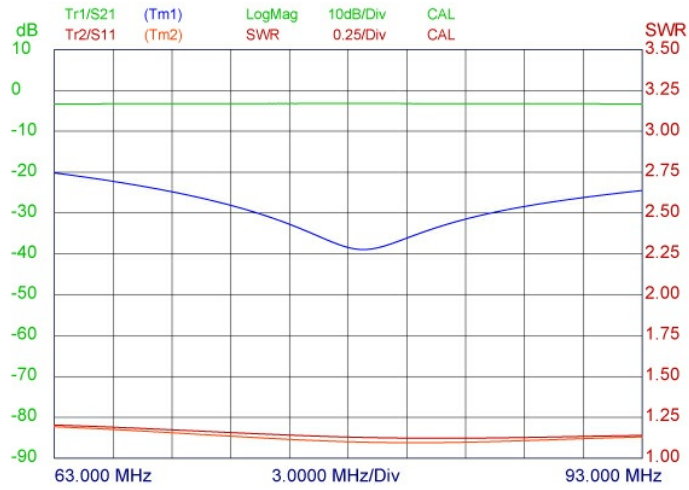

MOUNTING DETAILS

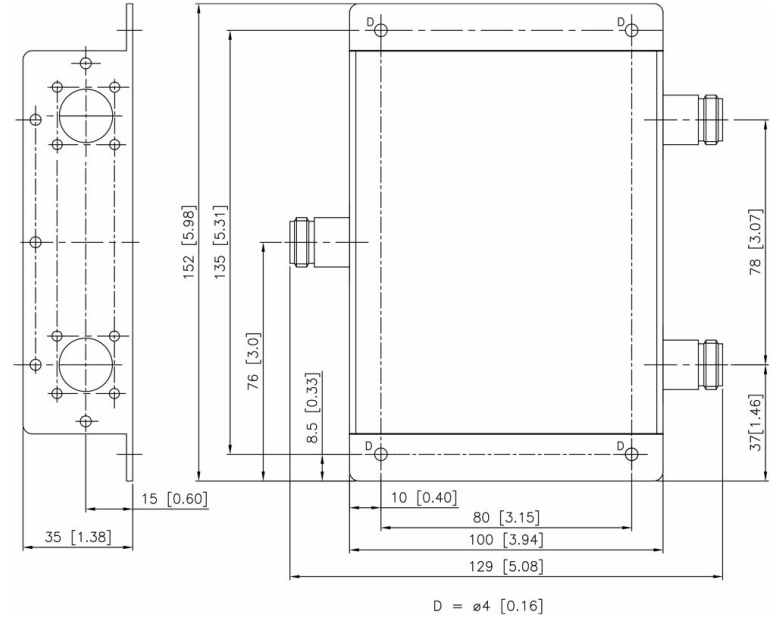

All dimension are given in mm [in.]

