

## Short Centre-loaded Mobile Antenna for the 30 MHz Band

### DESCRIPTION

- Short antenna with attractive appearance ideal for mounting on the car roof.
- High efficiency in spite of low height due to high-Q centre-loading coil and matching unit built into mount.
- Stainless steel ZP4-mount with ball-joint and wing screw whip-fastening system.
- Simple mounting exclusively with access from the outside.  
Models with roof thickness from 2 mm to 7.5 mm mounting from the inside.
- Delivered with 4 m cable permanently attached to the mount and terminated with FME-connector.



## SPECIFICATIONS

Electrical	
Model	CT 30-ZP4
Frequency	30 MHz
Antenna Type	Centre-loaded mobile antenna
Max. Input Power	200 W
Polarisation	Vertical
Impedance	50 $\Omega$
VSWR	< 1.3:1
Bandwidth	$\geq 350$ kHz @ VSWR $\leq 1.5$
Mechanical	
Materials	Whip : Stainless steel, Nylon, Chromed brass Mount : Chromed brass Weather- and shockproof plastics Stainless steel
Cable	4 m RG 58
Installation Torque	7.5 $\pm$ 1 Nm
Colour	Black / Metallic Silver
Height	Approx. 680 mm / 26.77 in.
Weight	Approx. 0.49 kg / 1.08 lb.
Mounting	21 mm / 0.83 in. dia. hole (For roof thicknesses 2 mm / 0.08 in. up to 7.5 mm / 0.30 in. mounting hole should be 22 mm / 0.87 in. dia.)
Mounting Plate Thickness	Max. 2.0 mm (Models up to 7.5 mm on request)

## ORDERING

Model	Product No.
CT 30-ZP4	130000601

## INSTALLATION

This antenna is supplied with type ZP4-mount. The whip is fastened to the mount by means of our standard ball-joint and wing screw system. The adjustable ball-joint ensures that the whip can always be mounted in a vertical position independent of the angle of the installation spot.

The ZP4-mount is particularly well suited for mounting on car-roofs because of its ability to be installed exclusively with access from the outside. The ZP4-Mount for roof thickness from 2 mm to 7.5 mm must be mounted from the inside. However, the antenna can be installed anywhere on the car, as the ZP4-mount is equally well suited for mounting on e.g. trunk or wing.

## 3. TUNING

The antenna should always be post-adjusted using an SWR-meter, especially if mounted near metal parts parallel to the whip. Loosen the union nut at the top of the coil and pull out the whip approx. 5 mm at a time until best possible VSWR is obtained. Fasten the union nut thoroughly.

## PLEASE NOTE

To make this antenna operate as efficiently as possible, a matching unit has been built into the antenna mount. Consequently, neither mount nor whip can be used together with other mounts/whips.

## 1. INSTALLATION DIMENSIONS

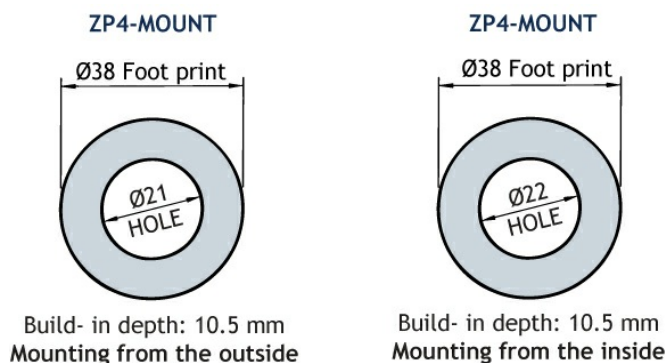

## 2. INSTALLATION STEPS

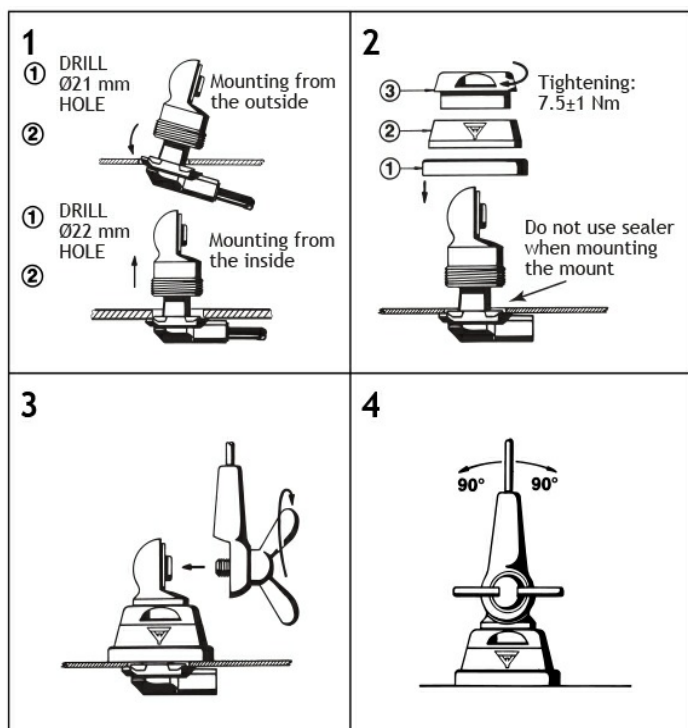

Do not use sealer on rubber gasket or other places.

