

Winkelhalter aus Edelstahl zur Montage von GPS 2000 Antennen

BESCHREIBUNG

- Winkelbeschlag zur Installation von GPS 2000 Antennen.
- Die Antenne wird auf den Winkelhalter gesetzt und mit der Sechskantmutter sowie der Zahnscheibe unten am Gewinde des Antennenanschlusses festgeschraubt.
- Application 1: Fixation on vertical structures such as:
 - ship's masts, cabins and rails
 - house roof ends.
 (Fixation by means of screws, bolts or rivets (not supplied)).
- Application 2: Fixation on vertical tubes (10 – 40 mm dia.)
 - (Fixation by means of steel binders (through the oblong holes)). (Not supplied).
- Application 3: Fixation on horizontal tubes (20 – 40 mm dia.) such as:
 - push and pulpit, rails and mast yards.
 - (Fixation by means of the supplied U-bolt fittings).

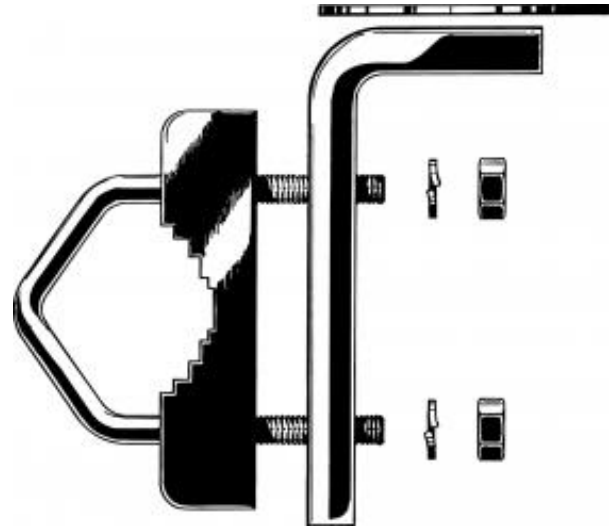

SPEZIFIKATIONEN

Elektrisch DE	
Modell	MB 2000
Anwendung	Angle bracket for antenna fixation
Mechanisch DE	
Materialien	Acid-proof, polished stainless-steel
Abmessungen	See below
Gewicht	Approx. 0.2 kg
Montage	On vertical surfaces with rivets, bolts or screws. On vertical tubing (10 - 40 mm dia.) with steel binders. On horizontal tubing (20 - 40 mm dia.) with U-bolt.

BESTELLUNG

Modell	Produkt Nr
MB 2000	110000016

MOUNTING DETAILS

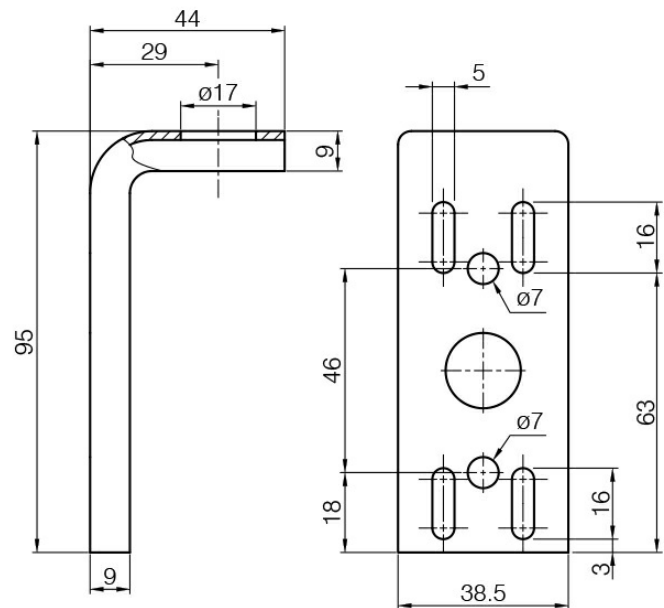

PLEASE NOTE

That an antenna should always be mounted as high and as unobstructed as possible. Objects in the vicinity of the antenna, especially parallel metallic parts (other antennas, wires etc.) may have considerable degrading influence on the VSWR and the radiation pattern of the antenna.